

SAE STANDARD CONNECTIONS

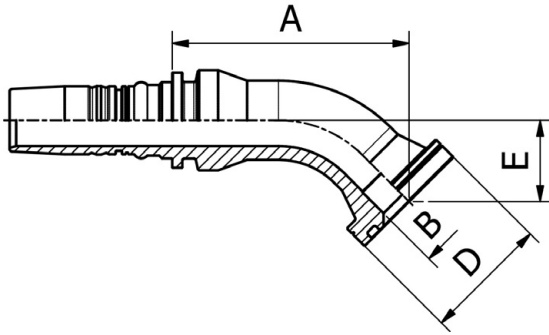

M43640

45° ISO / SAE
CODE 62 FLANGE
SAE J516 / ISO 12151-3

PART. REF.	HOSE BORE			Flange	DIMENSIONS mm						
	DN	Dash	inch		inch	B	A	D	E		
M43640-10-12	16	- 10	5/8"	3/4"	16.0	71.0	41.4	31.0			
M43640-10-16	16	- 10	5/8"	1"	20.0	83.5	47.7	32.5			
M43640-12-12	19	- 12	3/4"	3/4"	16.0	79.0	41.4	26.0			
M43640-12-16	19	- 12	3/4"	1"	20.0	85.5	47.7	32.5			
M43640-16-12	25	- 16	1"	3/4"	16.0	87.0	41.4	28.0			
M43640-16-16	25	- 16	1"	1"	20.0	90.0	47.7	31.0			
M43640-16-20	25	- 16	1"	1.1/4"	26.0	93.0	54.2	34.5			
M43640-20-16	31	- 20	1.1/4"	1"	25.0	106.5	47.7	33.5			
M43640-20-20	31	- 20	1.1/4"	1.1/4"	26.0	108.0	54.2	37.5			
M43640-20-24	31	- 20	1.1/4"	1.1/2"	32.1	116.0	63.7	42.5			
M43640-24-20	38	- 24	1.1/2"	1.1/4"	26.0	115.0	54.2	41.5			
M43640-24-24	38	- 24	1.1/2"	1.1/2"	32.0	125.0	63.7	44.0			
M43640-24-32	38	- 24	1.1/2"	2"	42.0	134.0	79.6	55.5			
M43640-32-32	51	- 32	2"	2"	42.0	152.0	79.6	58.5			
M43640-32-32056	51	- 32	2"	2"	42.0	149.5	79.6	56.0			

193 FITTINGS

SAE STANDARD CONNECTIONS

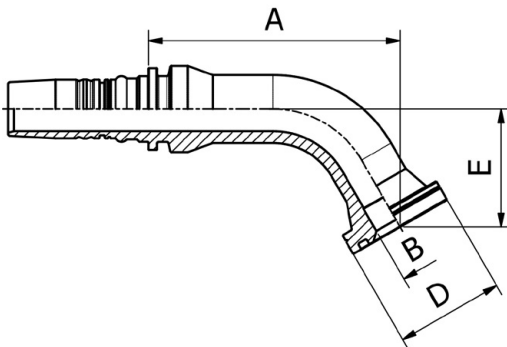

M43660

60° ISO / SAE
CODE 62 FLANGE
SAE J516 / ISO 12151-3

PART. REF.	HOSE BORE			Flange	DIMENSIONS mm						
	DN	Dash	inch		inch	B	A	D	E		
M43660-12-12	19	- 12	3/4"	3/4"	16.0	98.5	41.4	39.0			
M43660-12-16	19	- 12	3/4"	1"	20.0	101.0	47.7	44.0			
M43660-16-16	25	- 16	1"	1"	20.0	111.0	47.7	52.0			
M43660-20-20	31	- 20	1.1/4"	1.1/4"	26.1	133.0	54.2	58.0			
M43660-20-24	31	- 20	1.1/4"	1.1/2"	32.1	137.0	63.7	65.0			
M43660-24-24	38	- 24	1.1/2"	1.1/2"	32.0	155.0	63.7	59.0			
M43660-32-32	51	- 32	2"	2"	42.0	199.5	79.6	83.5			